



figure

823

ends
formthreaded
Y-type **STRAINERS**

body material	nominal pressure	nominal diameter	max temperature
A grey cast iron	C 16 bar	DN 10-80	200°C



correspond to the pressure equipment directive 97/23/EC
marking CE for Dn≥32

FEATURES

- compact settlement
- environment-friendly
- tests acc. EN - 12266 - 1
- screen made of stainless steel
- cleaning of screen without disassembling

APPLICATION

- hot and cold water plants
- steam plants
- industrial technologies
- power engineering
- heat engineering
- refrigeration and air conditioning

Data given can be changed without notice.

Edition 06/2011



MATERIALS

type 09;10 (DN 50-80)

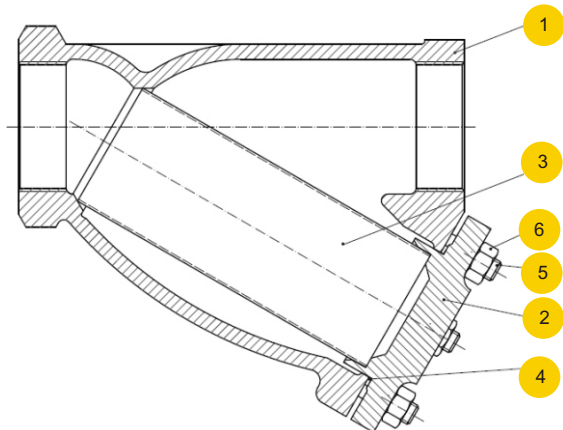

type 10 (DN 10-40)

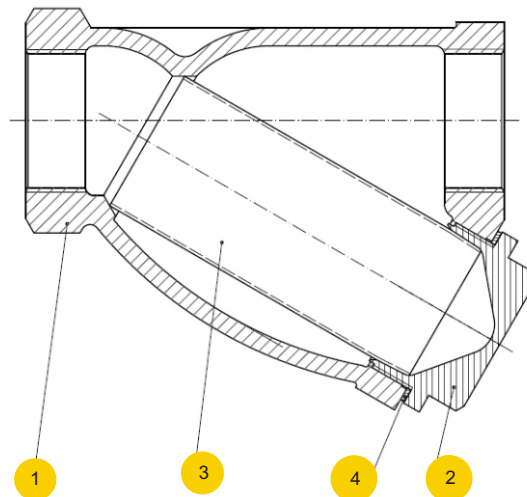

body material		A	
type		10 (DN 10-40)	09;10 (DN 50-80)
1	body	EN – GJL-250 JL1040	
2	cover	EN-GJS-500-7 JS1050	EN – GJL-250 JL1040
3	screen	X5CrNi 18-10 1.4301	
4	gasket	carbamide-caoutchouc	
5	studs	-----	8.8 A2A
6	hexagon nut	-----	8-A2A
max. temperature		200°C	



figure

823

ends
form

threaded
Y-type

DIMENSIONS

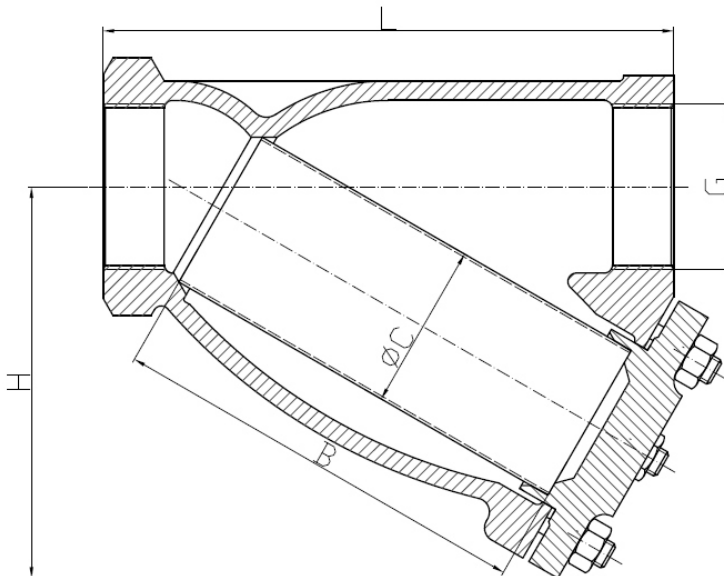

DN	PN 16							seal size			
	G	L	H	C	B	Kvs		Ø Dz	Ø Dw	g	
mm							m ³ /h	kg	mm		
10	3/8"	72	45	18	48	1,8	0,3	30	23	1,5	
15	1/2"	85	52	23	56	3,6	0,5	35	28		
20	3/4"	100	62	28	68	11,0	0,8	42	34		
25	1"	120	73	36	82	15,5	1,1	50	42		
32	1 1/4"	140	86	42	98	26,0	1,9	57	48		
40	1 1/2"	160	98	50	114	41,0	2,5	65	56		
50	2"	205	144	60	154	68,0	6,1	76	66		
65	2 1/2"	245	172	76	187	82,0	8,5	92	82		
80	3"	265	186	83	200	115	12,0	100	89		



figure

823

ends
formthreaded
Y-type

HYDRAULIC CHARACTERISTIC

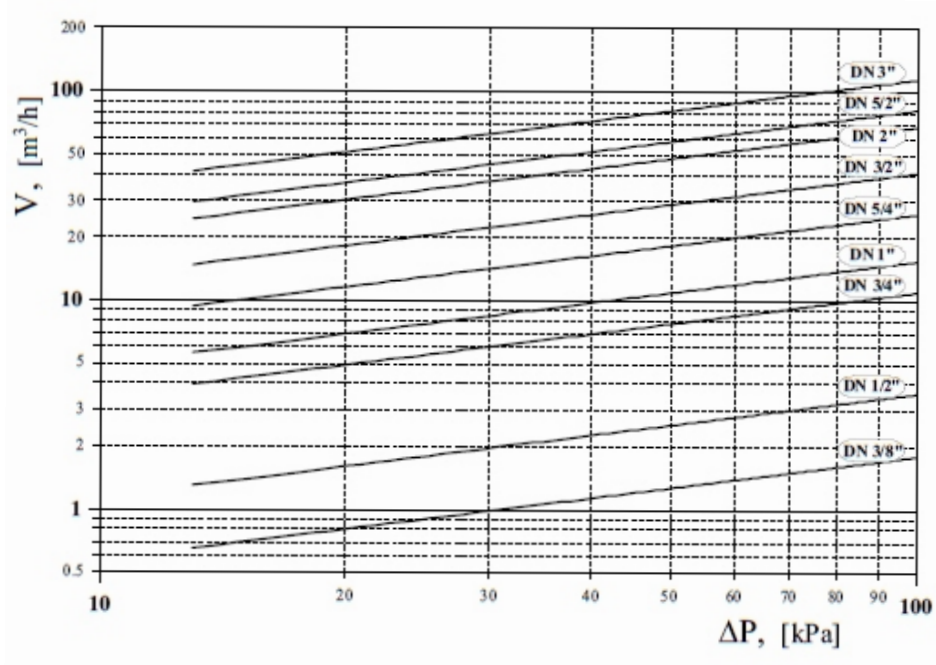

SCREENS

screen	type	DN	mash	meshes screen	performance
standard	F45	10-50	1,0	45	10
	F28	65-80	1.25	28	09
other performance	screen cartridges F100 (0,6), F200 (0,5), F300 (0,4), F400 (0,32), F600 (0,2)				



figure	823
ends form	threaded Y-type

PRESSURE-TEMPERATURE RATINGS

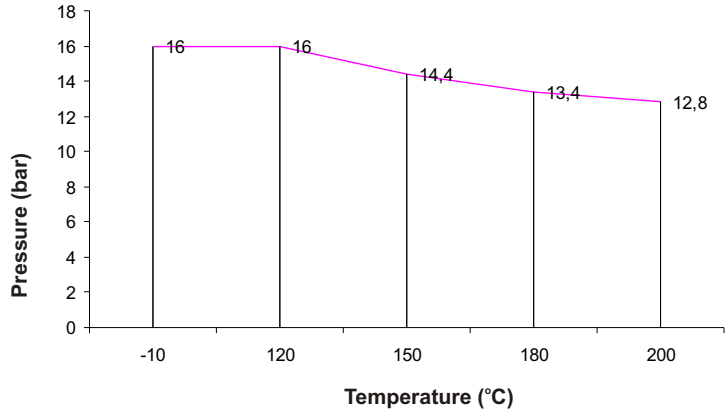

Allowed working conditions range
PN 16 EN-GJL-250



TYPES

figure	body material	nominal diameter DN	nominal pressure PN	type
823	A grey cast iron EN-GJL-250	10-50 mm	C 16bar	10 Tmax 200 °C • mesh 1,00 mm, 45 mesh/cm2
		65-80 mm	C 16bar	09 Tmax 200 °C • mesh 1,25 mm, 28 mesh/cm2
		10-50 mm	C 16bar	30 Tmax 200 °C • mesh 1,00 mm, 45 mesh/cm2 • with magnetic cartridge
		65-80 mm	C 16bar	29 Tmax 200 °C • mesh 1,25 mm, 28 mesh/cm2 • with magnetic cartridge
		10-80 mm	C 16bar	04 Tmax 200 °C • mesh 0,63 mm, 100 mesh/cm2
		10-80 mm	C 16bar	05 Tmax 200 °C • mesh 0,50 mm, 200 mesh/cm2
		10-80 mm	C 16bar	06 Tmax 200 °C • mesh 0,40 mm, 300 mesh/cm2
		10-80 mm	C 16bar	07 Tmax 200 °C • mesh 0,32 mm, 400 mesh/cm2
		10-80 mm	C 16bar	08 Tmax 200 °C • mesh 0,20 mm, 600 mesh/cm2
		10-80 mm	C 16bar	24 Tmax 200 °C • mesh 0,63 mm, 100 mesh/cm2 • with magnetic cartridge
		10-80 mm	C 16bar	25 Tmax 200 °C • mesh 0,50 mm, 200 mesh/cm2 • with magnetic cartridge
		10-80 mm	C 16bar	26 Tmax 200 °C • mesh 0,40 mm, 300 mesh/cm2 • with magnetic cartridge
		10-80 mm	C 16bar	27 Tmax 200 °C • mesh 0,32 mm, 400 mesh/cm2 • with magnetic cartridge
		10-80 mm	C 16bar	28 Tmax 200 °C • mesh 0,20 mm, 600 mesh/cm2 • with magnetic cartridge

Data given can be changed without notice.

Edition 06/2011



figure	823
ends form	threaded Y-type

ORDERING

To place an order please use our product number (index)



ORDER EXAMPLE

