



FLANGE STOP VALVE zGLO



Body material	Nominal pressure	Nominal diameter	Max. temperature
G Forged steel	1 Class 150 (20bar) 3 Class 300 (50bar) 6 Class 600 (100bar)	DN 15-50	425°C



according to Pressure Directive 2014/68/EU
CE marking for DN≥32

FEATURES

- high tightness (leakproof tightness class A according to EN - 12266 - 1)
- compact settlement
- environment friendly
- tests according to API 598 or EN 12266-1
- Installation length according to DIN 3202 for classes according to ANSI B16.10
- flange connections according to ASME B16.5 or PN-EN 1092-1

APPLICATION*

* not all of the applications are suitable for all of the material finishes

The website [atwww.zetkama.com.pl](http://www.zetkama.com.pl) contains a Chemical Resistance List, which specifies the operational characteristics for a certain medium.

industries							
	INDUSTRY	SHIPBUILDING INDUSTRY	HEATING	PETROCHEMICAL INDUSTRY	POWER ENGINEERING	CHEMICAL INDUSTRY	
media							
	GLYCOL	INDUSTRIAL WATER	DIATHERMIC OIL	STEAM	COMPRESSED AIR	NEUTRAL MEDIA	NATURAL GAS

Subject to design changes.

Edition 01/2023

ZETKAMA Sp. z o.o.
ul. 3 Maja 12
PL 57-410 Ścinawka Średnia

tel. +48 74 8652 187
ph. +48 74 8652 111
Fax +48 74 8652 199

E-mail spkraj@zetkama.com.pl
www.zetkama.pl

FIG. 208

MATERIALS, DIMENSIONS

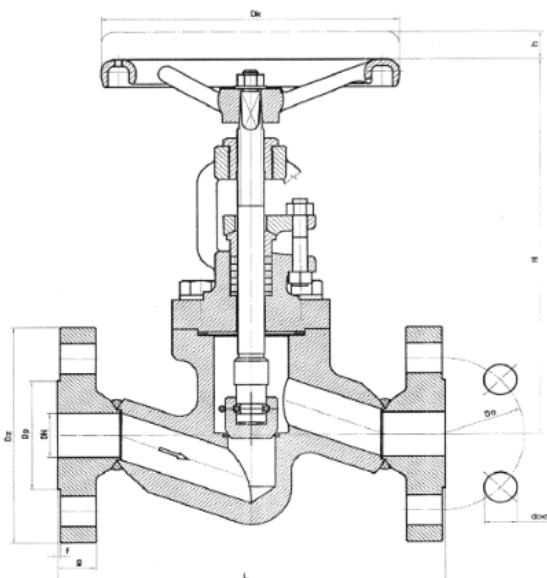

	Body material	G
	Type	01
1	Body	A105N
2	Bonnet	A105N
3	Stem	A182 F6a
4	Disc	A182 F6a
5	Hand-wheel	A197
6	Screw	A193 B7
8	Cover gasket	spiral wound gasket (steel + graphite)
9	Flange connection	A105N
Max. temperature		425°C

Class150

DN	Dz	Dp	Do	d	do x R	L	f	g	H	h	Dk	Weight
mm												kg
15	89	34.9	60.3	10	16x4	108	1.6	11.1	16	10	96	3.8
20	98	42.9	69	13	16x4	117.5	1.6	12.7	169	15	96	4.2
25	108	50.8	79.4	18	16x4	127	1.6	14.3	207	22	115	6.5
40	127	73.2	98.4	29	16x4	165	1.6	17.5	249	34	145	13.5
50	152	92.1	120.6	36	20x4	178	1.6	19.5	283	43	165	20

Subject to design changes.

Edition 01/2023

ZETKAMA Sp. z o.o.
ul. 3 Maja 12
PL 57-410 Ścinawka Średnia

tel. +48 74 8652 187
ph. +48 74 8652 111
Fax +48 74 8652 199

E-mail spkraj@zetkama.com.pl
www.zetkama.pl

FIG. 208

Class300

DN	Dz	Dp	Do	d	do x R	L	f	g	H	H	Dk	Weight
Mm												kg
15	95.3	35.1	66.5	10	16x4	140	1.6	142	165	10	96	4
20	117.3	42.9	82.6	13	19x4	152.5	1.6	15.8	169	15	96	4.5
25	124	50.8	88.9	18	19x4	165	1.6	17.5	207	22	115	6.8
40	155.4	73.2	114.9	29	22x4	190.5	1.6	20.6	249	34	145	14
50	165	92.1	127	36	20x8	216	1.6	22.4	283	43	165	21

Class600

DN	Dz	Dp	Do	d	do x R	L	f	g	H	H	Dk	Weight
Mm												kg
15	95.3	35.1	66.5	10	16x4	140	1.6	142	165	10	96	4
20	117.3	42.9	82.6	13	19x4	152.5	1.6	15.8	169	15	96	4.5
25	124	50.8	88.9	18	19x4	165	1.6	17.5	207	22	115	6.8
40	155.4	73.2	114.9	29	22x4	190.5	1.6	20.6	249	34	145	14
50	165	92.1	127	36	20x8	216	1.6	22.4	283	43	165	21

PRESSURE-TEMPERATURE RATINGS

		Temperature [° C]						
Material	Pressure	-29 < up to <38	100	200	300	350	40	425
A105N	Class150 [bar]	19.6	179	14	10.2	8.4	6.5	5.6
	Class300 [bar]	51.1	46.4	43.8	38.7	37	34.5	29.8
	Class600 [bar]	102.1	92.8	87.6	77.5	73.9	69	57.5

Options:

Various configurations are possible upon a customer's request.

Subject to design changes.

Edition 01/2023

TYPE

Figure	Body material	Nominal diameter	Nominal pressure	Type
208	G Forged steel A105N	15-50 mm	1 Class 150	01 stem and poppet connection detachable; stem, poppet - stainless steel
			3 Class 300	01 stem and poppet connection detachable; stem, poppet - stainless steel
			6 Class 600	01 stem and poppet connection detachable; stem, poppet - stainless steel

ORDERING

Figure	Body material	Nominal diameter	Nominal pressure	Type
208	G Forged steel A105N	15-50 mm	1 Class 150	01 stem and poppet connection detachable; stem, poppet - stainless steel

An example of index-based order

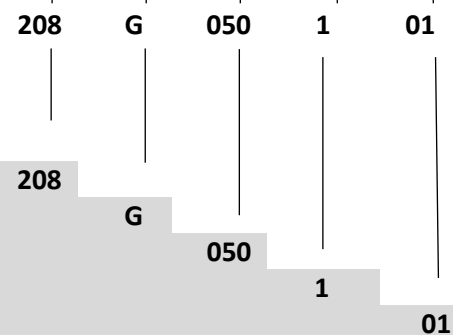

Flange stop valve, straight form	208
Forged steel A105N	G
Nominal diameter (mm)	050
Nominal pressure Class 150	1
Stop valve; stem, poppet - stainless steel	01

Subject to design changes.

Edition 01/2023