

STOP VALVES zFAG



Body material	Nominal pressure	Nominal diameter	Max. temperature
G Forge steel	F 63 bar	DN 15-25	450°C
	G 100 bar	DN 15-25	
	H 160 bar	DN 15-50	
F Cast steel	F 63 bar	DN 32-200	450°C
	G 100 bar	DN 32-200	
	H 160 bar	DN 65-200	
Q Alloy steel	F 63 bar	DN 15-200	550°C
	G 100 bar		
	H 160 bar		



correspond to the pressure equipment directive 2014/68/UE marking CE for DN≥32

FEATURES

- high tightness (leakproofness class - A acc. to EN - 12266 - 1
- compact settlement
- environment friendly
- tests acc. to EN - 12266 - 1
- face-to-face dimension according to EN 12982 series 65 for DN 25-50
- welded ends acc. EN 12627

APPLICATION*

* not all of the applications are suitable for all of the executions
On the website www.zetkama.com.pl is a Chemical Resistance List, which specifies the parameters of work for a given medium.

industries



INDUSTRY



SHIPBUILDING
INDUSTRY



HEATING



PETROCHEMICAL
INDUSTRY



POWER
ENGINEERING



CHEMICAL
INDUSTRY

media



GLYCOL



INDUSTRIAL
WATER



DIATHERMIC OIL



STEAM



COMPRESSED
AIR



NEUTRAL
FLUIDS

Data given can be changed without notice.

Edition 01/2021

MATERIALS, DIMENSIONS

DN 15-25 PN63, 100
DN 15-50 PN160

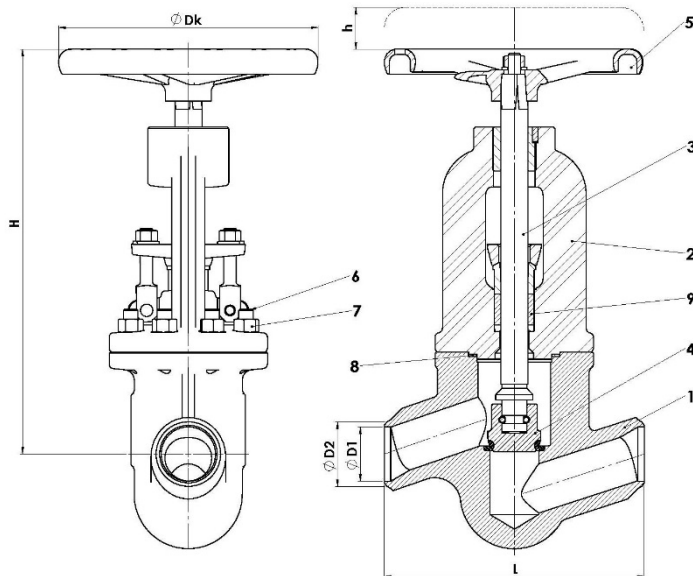

	Body material	G	Q
	Type	00	00
1	Body	P245GH 1.0352	13CrMo4-5 1.7335
2	Bonnet	P245GH 1.0352	13CrMo4-5 1.7335
3	Stem	X20Cr13+QT 1.4021	X22CrMoV12-1+QT 1.4923
4	Disc	X17CrNi16-2+QT 1.4057	13CrMo4-5 + stellit 1.7335
5	Hand-wheel	EN-GJS-500-7	
6	Stud bolt	42CrMo4+QT 1.7225	X22CrMoV12-1+QT 1.4923
7	Nut		
8	Bonnet gasket	spiral gasket(steel + graphite)	
9	Gland packing	Graphite	
Max. temperatura		450°C	550°C

DN	15	20	25	32	40	50
L (mm)	160	160	160	180	210	250
Dk (mm)	120	120	160	200	200	250
H	195	195	255	270	270	390
h	12	12	14	18	18	40
Weight (kg)	3,75	3,60	7,50	8,50	12,50	21,5

Data given can be changed without notice.

Edition 01/2021

ZETKAMA Sp. z o.o.
Ul. 3 Maja 12
PL 57-410 Ścinawka Średnia

Tel. +48 74 8652 193
Tel. +48 74 8652 111
Fax +48 74 8652 199

E-mail export@zetskama.com.pl
www.zetskama.com

DN 32-200 PN63, 100

DN 65-200 PN160

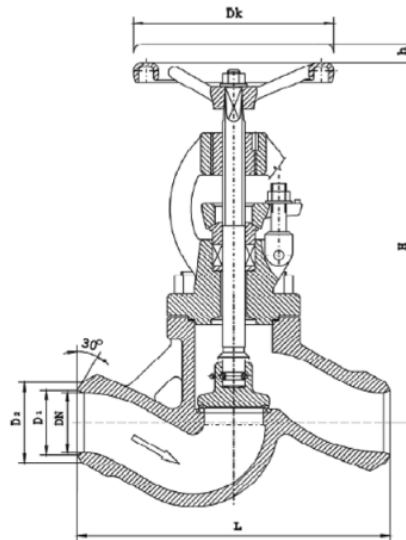

	Body material	F	Q
	Type	01 04	01 04
1	Body	GP240GH	G17 Cr Mo 5 5
2	Seat ring (padding)	18-8 Cr-Ni	Stellite
3	Bonnet	GP240GH/P265 GH	G17 Cr Mo 5 5/13 Cr Mo 4 5
4	Stem	X20Cr13	1.4923
5	Disc (padding)	18-8 Cr-Ni	Stellite
6	Gasket	Graphite	Graphite
Max. temperature		450°C	550 °C

DN	65	80	100	150	200
L	340	380	430	550	650
H	360	380	500	580	727
h	35	48	55	70	85
Dk	280	360	360	400	500
Weight (kg)	30,5	37,8	95,0	200	---

Data given can be changed without notice.

Edition 01/2021

ZETKAMA Sp. z o.o.
Ul. 3 Maja 12
PL 57-410 Ścinawka Średnia

Tel. +48 74 8652 193
Tel. +48 74 8652 111
Fax +48 74 8652 199

E-mail export@zetkama.com.pl
www.zetkama.com

PRESSURE-TEMPERATURE RATINGS

Material	PN	Temperature [° C]																		
		-10 < do <50	100	150	200	250	300	350	400	450	460	470	480	490	500	510	520	530	540	550
P245GH GP240 GH	63	63	58,5	55,5	52,5	48,0	43,5	40,5	37,5	20,7	-	-	-	-	-	-	-	-	-	-
	100	100	92,8	88,0	83,3	76,1	69,0	64,2	59,5	32,8	-	-	-	-	-	-	-	-	-	-
	160	160	148,5	140,9	133,3	121,9	110,4	102,8	95,2	52,5	-	-	-	-	-	-	-	-	-	-
13CrMo4-5 G17 CrMo 5-5	63	63	63	63	63	63	63	60,0	56,7	53,1	50,5	47,9	45,4	42,8	41,1	34,8	28,2	23,4	18,3	14,7
	100	100	100	100	100	100	100	95,2	90,0	84,2	80,2	76,1	72,0	68,0	65,2	55,2	44,7	37,1	29,0	23,3
	160	160	160	160	160	160	160	152,3	144,0	134,8	128,3	121,8	115,3	108,8	104,3	88,3	71,6	59,4	46,4	37,3

DIMENSIONS OF WELDING ENDS

DN		15	20	25	32	40	50	65	80	100	150	200
PN63	D1 (mm)	17	22	28	37	43	54	70	82	104	154	204,5
	D2 (mm)	22	28	34	43	54	67	83	96	115	176	223
PN100	D1 (mm)	17	22	28	37	43	54	70	82	104	154	199,5
	D2 (mm)	22	28	34	43	54	67	83	96	115	176	223
PN160	D1 (mm)	17	22	27	35	41	51	65	76,5	98,5	144,5	189
	D2 (mm)	24	28	34	43	49	62	77	91	117	172	223

Other type of valves on request:

- stellited seat
- hardened disc
- stellited disc
- other

Data given can be changed without notice.

Edition 01/2021

TYPE

Figure	Body material	Nominal diameter	Nominal pressure	Type
217	G Forged steel P245GH	15-50 mm	H 160 bar	00 stem and disc connection - fixed; stem, disc -stainless steel
		15-25 mm	G 100 bar	00 stem and disc connection - fixed; stem, disc -stainless steel
		15-25 mm	F 63 bar	00 stem and disc connection - fixed; stem, disc -stainless steel
	F Cast steel GP240GH	65-200 mm	H 160 bar	04 stem and disc connection - separable; balancing disc; stem, disc -stainless steel
		32-65 mm	G 100 bar	01 stem and disc connection - fixed; stem, disc -stainless steel
		32-65 mm	F 63 bar	01 stem and disc connection - fixed; stem, disc -stainless steel
		80-200 mm	G 100 bar	04 stem and disc connection - separable; balancing disc; stem, disc -stainless steel
		80-200 mm	F 63 bar	04 stem and disc connection - separable; balancing disc; stem, disc -stainless steel
		Q Alloy steel 13CrMo4-5	15-50 mm	H 160 bar
	15-25 mm		G 100 bar	00 stem and disc connection - fixed; stem, disc -stainless steel
	15-25 mm		F 63 bar	00 stem and disc connection - fixed; stem, disc -stainless steel
	Q Alloy steel G17CrMo5-5	65-200 mm	H 160 bar	04 stem and disc connection - separable; balancing disc; stem, disc -stainless steel
		32-65 mm	G 100 bar	01 stem and disc connection - fixed; stem, disc -stainless steel
		32-65 mm	F 63 bar	01 stem and disc connection - fixed; stem, disc -stainless steel
		80-200 mm	G 100 bar	04 stem and disc connection - separable; balancing disc; stem, disc -stainless steel
		80-200 mm	F 63 bar	04 stem and disc connection - separable; balancing disc; stem, disc -stainless steel

Data given can be changed without notice.

Edition 01/2021

ORDERING

Figure	Body material	Nominal diameter	Nominal pressure	Type
217	G Forged steel P245GH	15-50 mm	H 160 bar	00 stem and disc connection - fixed; stem, disc -stainless steel

Order example acc. index

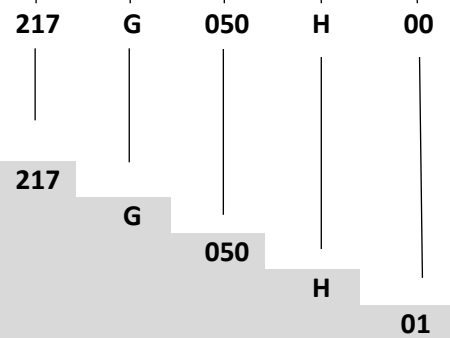

Stop valve, ends welded, form straight
 Forged steel P245GH
 Nominal diameter (mm)
 Nominal pressure PN 160
 Stem and disc connection - fixed; stem, disc -stainless steel

Data given can be changed without notice.

Edition 01/2021