

USER MANUAL		
SPRING-LOADED SAFETY VALVES zARMAK	240, 270, 610, 613, 614, 630, 650, 670, 673, 674, 775	Edition: 06/2019 Date: 06.10.2019

TABLE OF CONTENT

1. Principle of operation
2. Delivery condition
3. Installation of safety valves
4. Operation of safety valves
5. Adjustment of the set pressure
6. Maintenance and repair of safety valves
7. Operating disturbances and their elimination
8. Valve service discontinuity
9. Warranty



Figure 240



Figure 630



Figure 775

1. Principle of operation

The purpose of the safety valve is to protect the equipment and installation against excessive pressure, above the pressure limit.

When the force coming from the pressure acting on the disc surmount with the force from the spring, the valve starts to open. A further increase in the pressure, required for the particular design of the valve, causes its full opening aided by the bell (figure 1 pos. 4 and figure 4 pos. 4).

2. Delivery condition

Supplied valves are tested and set for the required opening pressure or, when ordered for range, for the upper pressure of the range. Valves are stamped on a nameplate fixed to the body and with the signs on the edge of the outlet flange.

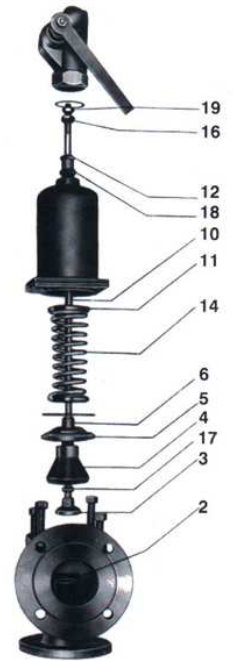

Drawing 1



Nameplate

Symbols:

- 1 Type of safety valve
2. Bore diameter
3. Spring number
4. The discharge coefficient for vapours and gases
5. Set pressure or set pressure range
6. Flow area
7. Year of manufacture
8. The minimum lift value
9. Overpressure
10. The discharge coefficient for liquids
11. Cold Differential Test Pressure
- * Notified body number

Additionally, the outlet flange is marked with:

1. Spring number
2. Pressure range or opening pressure

3. Year of manufacture / serial number
4. Workstation number of assembler
5. Stamp of an operator performing the test

Set pressure is secured by sealing between the cap and bonnet.

In order to secure the valve during transport, the lever is being attached to the outlet flange with a wire, and the flow holes are being plugged. The external surfaces of the valve are painted.

In addition, the outer surfaces of the valve are painted to protect them against corrosion during transport and storage.

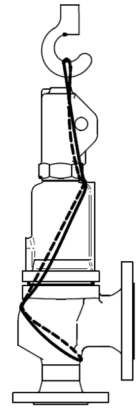

Drawing 2

3. Installation of safety valves

- Before the installation on the unit or pipeline, check if valve was not damaged or contaminated during transport. It is necessary to check the cleanliness of flow channels, external surfaces and end connections. Surfaces of flanges should be cleaned of preservative and of any possible impurities.

⚠ To lift safety valves rope should be used on the body and bonnet in accordance with fig. 2. Do not lift the valve at the lifting lever

⚠ The valve should be mounted in a vertical position.

- After installing the valve, loosen the lever by removing the wire.
- Pipes connected to the valve should comply with the requirements included in the surveillance provisions. Cross-section and shape of the pipes should be selected so that they do not reduce the capacity of the valve. If the medium is discharged with one pipeline from a few safety valves, free area of the flow of this pipeline should be at least equal to the total area of outlet ports flow of these valves. Moreover, the pipes should be made advantageously to the flow (gentle curves). For valves equipped with drainhole condensate drainage should be used. For valves that do not have drainhole, drain should be provided at the lowest point of the discharge pipe.

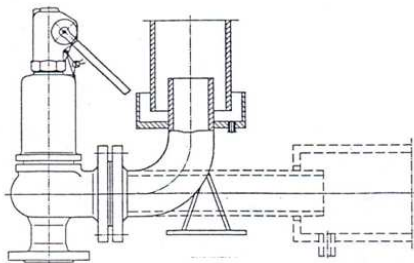

Drawing 3.

- Full-lift safety valves from the range of O2 from DN 40 has a cast support lugs at the body, used with appropriate mounting to take the reaction forces over by the outlet.
- In order to avoid reaction forces at the outlet connection of the valve, it is required to use an appropriate support to the pipeline.
- For the vapours and gases outlet port cannot be rigidly connected to the pipeline. Exemplary flexible connection of the outlet with the pipeline was shown in drawing 3.
- The valve cannot act like a support structure for the pressure equipment on which it is mounted, and it cannot be exposed to deformation caused by installation of inlet and outlet pipes.
- When mounting the valve flange with the flange of the pressure equipment, use the appropriate gasket (adapted to the type of valve face and with respect to parameters and medium type).
- Flange bolts should be tightened evenly and with crisscross pattern. They should also be tightened after a certain period of operation of the valve or in the event of a leak.

- Mounting place of the valve should be easily accessible, good lighted and protected from external influences. If the safety valve is mounted outdoors, it must be protected against frost and rain. When mounted near the platforms for service, they must be in compliance with the provisions of Health and Safety Regulations (blowing valve should not be a threat to the health and life of people).

4. Operation of safety valves

Figure 630A, 630C, 630F(R) E

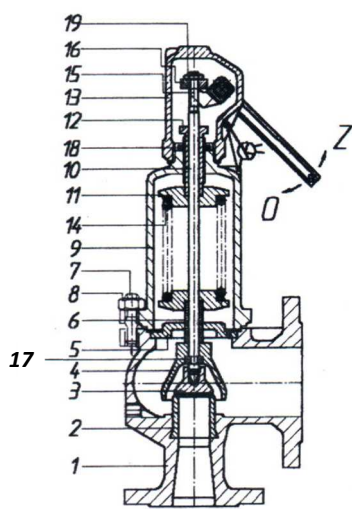

Drawing 4

Nr poz.	Materials
1.	Body
2.	Seat/ Nozzle
3.	Disc
4.	Lifting bell
5.	Guide
6.	Sleeve
7.	Stud
8.	Nut
9.	Bonnet
10.	Spindle
11.	Spring plate
12.	Adjusting screw
13.	Cap
14.	Spring
15.	Cam
16.	Lifting nut
17.	Thrust ring
18.	Lock nut
19.	Nut

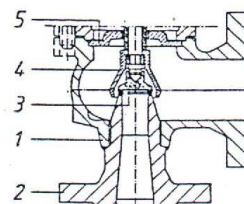

Figure 630F F(G)

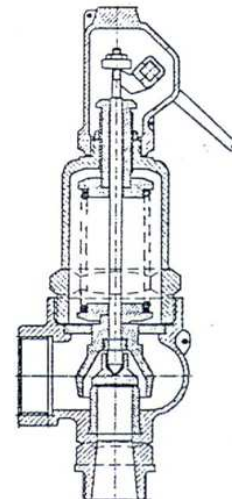

Figure 775

Positions as for figure 630A, 630C, 630F(R) E

Safety valves that serve as important elements of the devices and pressure systems require particularly careful and competent service. Any operational gasp may cause damage to the valve mechanism, and consequently lead to the total failure of the pressure system. Therefore, during the operation, pay special attention to:

- Proper setting of safety valve, suitable for the operating parameters of the equipment being protected.
- Proper protection of the valve mechanism against arbitrary regulation and the possibility of damage.
- Periodically verification of correct operation of the valve, in accordance with the requirements of surveillance.
- Proper maintenance and repair management.

Checking the safety valve operation involves lifting of the disc with a lever, running it in the direction indicated in Figure 4. Starting the lever causes loosening of the spring force thereby allowing the minimum lift of the disc and the flow of medium.

Release of the lever should be made at a pressure between 75% and 85% of set pressure. Keep in mind that too frequent checking may result in damage to the sealing surfaces of the valve disc and seat and thus to a loss of tightness, and the complete lack of checking usually leads to "seizing" of the valve mechanism, what can have serious consequences.

The frequency of these activities depends primarily on:

- Conditions of exploitation, i.e. the type of medium flowing and its parameters
- The specifics of the technological process;
- Place of installation;
- Environment;

It should also be correlated with the overhaul and repair of pressure equipment / installations that protects the valve. Very important is the experience of the user. Determining the periods of checking the safety valve is the responsibility of the designer of installation.

 **After checking of the valve, move the lever to the original position.**

When checking the valve there is a possibility of contamination the sealing surfaces. In this case, again lift disc to remove these pollutions. If tightness was not obtained by this, the valve needs to be reginded from the next stop of the pressure device.

In the case of valves with soft sealing, any damage at the rubber surface of the disc requires replacement.

 **Safety valve are not designed to use as a discharge valve, and inappropriate use dismiss producer from any obligation and warranty.**

5. Adjustment of the set pressure

 **The pressure may be adjusted by an authorized person, i.e. Authorized Technician and Inspector of a Notified Body (UDT, TUV). To change the response pressure or replace the springs, the seal must be removed, which causes the warranty to expire.**

Set pressure of the valve can be adjusted only within the range of the provided spring, for this purpose:

1. Remove the seal between the cap (13) and bonnet (9)
2. Lift the handle all the way in the close direction
3. Unscrew the cap
4. Loosen the lock nut (18)
5. Turn the adjusting screw to achieve the required pressure for the opening, in order to protect the surface of the sealing, while turning an adjusting screw hold the spindle with the lifting nut (16) preventing it from rotation
6. Lock the lock nut (18)
7. Turn the cap on with a new gasket

6. Maintenance and repair of safety valves

In order to ensure correct operation of safety valves, the following conditions must be meet:

- valve disc cannot set slantwise to the valve seat
- sealing surfaces of the seat and disc should ensure tight closure of the valve;
- All cooperating moving parts of valve mechanism should maintain movability in operating conditions.

In order to maintain these conditions the valves should be periodically inspected and renovated. Inspections of safety valves should be conducted by persons with adequate authorisation. While the repairs should be first carried out by the manufacturer of the safety valve or at authorized service centres, or by the user's service teams having appropriate permissions.

 **In the case of valves working at hard conditions (such as high temperature and / or pressure above 4.0 MPa) you should take into account the need for revision of the valve after each opening.**

 **In addition to the recommendations included in these instructions, the requirements and recommendations resulting from the surveillance provisions of the country in which safety valve is operated also apply.**

7. Causes of operating disturbances and their elimination

Disturbance	Possible causes	Elimination
Safety valve does not work - no flow or slight flow	Protective cap of the inlet flange has not been removed prior to installation of the valve	Remove inlet flange protective cap.
	Mechanical components left in the system – they blocked the flow of the medium into the valve	Remove the valve from the system and clean inlet of the valve.
	incorrect installation of the valve - the flow of the medium is opposite with the direction marked on the valve body	Install the valve correctly, in accordance with the indications of manufacturer's instructions.
	Blocking screw is installed	Remove blocking screw and plug the hole in cap.
	Too high set pressure, inadequate to the requirements of secured installation	If the required pressure is within the scope of spring mounted on the valve- set the safety valve to the required pressure, if it is outside the scope of spring mounted - replace the spring with the appropriate one and set the required pressure. In each case, act in compliance with manufacturer's instructions. If the required pressure does not fall within the scope of the safety valve type mounted - replace the valve with the appropriate type, with set pressure adjusted to the required pressure.
	backpressure not taken into consideration (in case of conventional valve, i.e. unbalanced)	For stable superimposed backpressure - set the differential pressure. For variable superimposed backpressure - apply bellows compensating backpressure changes In each case, follow manufacturer's instructions and with matters requiring clarification - consult the manufacturer's technical advisor.
	Sticky medium	Use the valve with bellows and a heating jacket, optionally incorporate security plate into the system.
	Freezing or solidifying medium	The body and the pipes should be kept in a state incapable freezing or solidifying of media - apply the heating.
	"Seizing" of the sealing surfaces of the seat and valve disc preventing their separation at the set pressure	If the properties of the medium and the operating conditions do not exclude such possibility - appropriate frequency of inspections and repairs of the safety valve must be adapted, and the time of valve check provided in the operating records of protected device / system should be strictly observed.
No repeatability of valve opening pressure (conventional valves, ie. unbalanced)	Variable superimposed backpressure	Replace conventional safety valve with the valve with bellows compensating superimposed backpressure changes.
checking of safety valve is not possible	Inlet pressure is lower than 75% of the set pressure	check the safety valve with a proper pressure – follow manufacturer's instructions.

	Lever wire used for transport is not removed.	Remove the lever wire.
	Damages within the lifting unit	Inspect the lifting unit and when necessary replace damaged parts to new ones.
Leak at sealing surface	Incorrect transport or storage - wrong position during transport and storage, protective cap from the inlet and outlet of the valve have fallen out and thus the impurities entered into the valve	During transport and storage follow manufacturer's instructions. If the inner part of the valve has been polluted, it need to be cleaned before installing the valve in the system in order to avoid damage to the sealing surfaces.
	Working pressure is higher than 90% of set pressure. There is no corresponding relationship between the set pressure and the working pressure.	Working pressure has to be lower than 90% of set pressure. For correct pressures for safety valve use values recommended by manufacturer.
	Lever not in neutral position (in case of closed valves and low pressures)	Move the lever to the neutral position.
	Vibrations of the safety valve	Diagnose the cause of these vibrations, and if possible - remove the source. If the vibrations cannot be prevented mount appropriate damping systems. If the chattering of the valve is due to incorrect valve selection (see "Vibration") - analyse the accuracy of the valve selection and if necessary replace it.
	Medium pollutions, foreign substances between the disc and seat	Shortly lift valve disc to remove any impurities, and if it does not bring the expected results – take off the valve and perform regeneration of the sealing surfaces of the seat and the disc or replace it with new one. If it is possible - apply valve with soft seal on the valve disc, which has a lower sensitivity to grit in the seat. Follow manufacturer's instructions.
	Corrosion of elements directly in contact with the medium, which is the result of improper valve selection in respect of material	Replace the valve with the construction appropriate to the medium according to resistance of used materials or apply safety valve system with a bursting disc
	The deformation caused by stresses of the installation. Valve bodies can get deformed due to excessive load transferred from the pipes, causing, among others, leaking.	Diagnose and eliminate the causes of stress. If the deformations of valve body are permanent- replace the safety valve with a new one.
	Other causes of leaks on the seat.	Depending on the reason diagnosed - according to the indications and decision of the manufacturer - replace the defective parts or replace the safety valve with a new one.
	With the cold setting of a valve, appropriate temperature adjustment was not included. (in case of valves used for media of 100°C and higher)	Revise opening pressure, observing the guidelines and recommendations of the manufacturer.

Safety valve opens at a pressure lower than at adjusted set pressure	High spring relaxation at the working conditions (for valves at upper limit for medium and temperature / pressure)	Consult the manufacturer-replace the spring, according to the guidelines and recommendations of the manufacturer. If possible- apply the valve with open bonnet construction (better cooling of a spring) or / and with cooling section. When such situation reoccurs – replace the valve with a new one, intended for a use in higher temperature range.
	Slight damage or contamination of the sealing surface of the seat / disc	Remove the valve, check the sealing surfaces and, if necessary - make regeneration according to the manufacturer's instructions and recommendations.
	The valve is set to the differential pressure (considering the presence of superimposed backpressure) when the backpressure don't exist	Regulate setting of the valve. If the required pressure is within the scope of spring mounted on the valve- set the safety valve to the required pressure, if it is outside the scope of spring mounted - replace the spring with the appropriate one and set the required pressure. In each case, act in compliance with manufacturer's instructions.
Sudden increases in pressure (pulsations)	Incorrect positioning of the safety valve at pressure source	Analyse positioning of the safety valve at pressure source. Safety valve should be installed in such a distance from pressure source that protects it from the pressure pulsations.
Crack in the flange of safety valve body	Transport defect	Replace safety valve
	defect of the material	Replace safety valve
	Installation errors	Replace safety valve. Strictly follow manufacturer's instructions and the requirements of the relevant provisions in terms of requirements for installation of safety valves – do not induce stress during installation.
Crack in the flange of safety valve body	Forces like bending, or torque act on safety valve.	Replace safety valve. When designing the installation check the manufacturer's instructions and the requirements of the relevant provisions of supervision institutions in the requirements for pipes connected to the safety valve, taking into account all the possible reaction forces occurring at the outlet, provide for appropriate support, do not let the valve to be a supporting structure for the other elements of the installation. Consider the possibility to use safety valves with support lugs.
	Too high flow resistance in the supply line - pressure loss in the supply line exceeds 3% (set pressure of safety valve)	Reduce flow resistance in the supply line. If this is not possible, for some reasons - consider the possibility of a safety valve with damper. Effectiveness of this valve construction is possible in particular conditions – clarify with the manufacturer.
	Wrong characteristic of the safety valve in the protected installation	Analyse this matter, taking into consideration special conditions. If such

Vibrations		adjustment is not possible- replace the valve with a new one with a proper characteristics.
	The valve was designed with too large capacity in relation to the requirements of protected installation.	Analyse the selection of safety valve – apply smaller valve, respectively to the required capacity.
	Built-up backpressure occurring in the discharge line at the blow out from the valve - exceeds the value allowed by the manufacturer (10 ÷ 15% of the set pressure) -e.g. too long outlet pipe, its diameter is too small, rapid changes in the direction of flow, the use of silencers, etc.	If it is not possible to introduce changes to the construction of discharge line, reducing built-up backpressure - apply valve with bellow compensation
	Excessive fluctuation of the superimposed backpressure at the outlet of the valve (in the case of the conventional valve i.e. unbalanced)	Apply valve with bellow resistant to influence of changing superimposed backpressure.
	Too large construction lift of closing element (e.g. in case of full stroke safety valves used for fluids)	Apply safety valve of characteristics adjusted to this type of fluids, or- if the manufacturer enables such construction- reduce the construction lift of the full lift valve to the value indicted by the manufacturer.
	Incorrectly made welds on connecting pipes, too small gaskets on inlet and outlet or gaskets placed incorrectly (non-centrally) disrupting the flow	Eliminate incorrectness
Pressure in installation still rising despite open safety valve	Inadequate selection of the safety valve – too small capacity of the valve in relation to the installation requirements	Reselect the valve considering the required capacity and replace it with a proper one.
Safety valve constantly releases medium	Valve spring is broken – as a result of corrosive medium or destroyed by a different factor	Replace the spring or the entire safety valve. In case of steam – consider the possibility of applying valve with open bonnet.
	“hangs” of the valve (the valve opened but did not close)	Diagnose the cause of the “hangs” If it is not possible to eliminate the reason- replace the valve.
	Very large damage to the surface of sealing, e.g. as the result of long-term leakage, crack of seat, “pitting” due to the medium	Replace the valve with a new one.
	Pressure do not fall down to closing pressure	Preserve adequate ratio between working and closing pressure according to ISO-4126-1
Crew injuries at discharge condition and external medium leakage	Use of safety valve of the open construction in contrary to the safety regulations and manufacturer’s instructions (e.g. near the platforms for service staff)	If the operational parameters allow it - replace the valve with the one with closed bonnet and if it is not possible—install proper protecting covers.
	Use of safety valve without external tightness test confirmed by the manufacturer	Use valve with gastight construction, that is with external tightness test of the valve.

	Use of valve in which sealing is not adequate to the properties and parameters of medium.	Replace sealing in the operating valve with the adequate one (after consulting the manufacturer) or replace the entire valve.
	Incorrect discharge of medium from the safety valve	In case of steams and gases, the discharging pipe should be directed upwards, enabling safe discharge, minding that outlet end connector cannot be rigidly connected to the pipeline. In addition, in each case, the safety valve outlet flange (free discharge into the environment) or drain line must be positioned so that the flowing medium does not pose a threat to the environment. Follow the requirements of supervising institutions regulations and indications and recommendations of the manufacturer.
	Incorrect drainage medium form the valve and form the discharge pipe.	Eliminate the incorrectness in the drainage line, following the requirements of supervising institutions regulations and indications and recommendations of the manufacturer.
Condensate in the expansion chamber of the safety valve	Improper drainage installation - discharging fluid from the safety valve, improper drainage installation, clogged drainage system	Eliminate the incorrectness in the discharge and drainage installations. In the lowest point of discharge installation it is required to apply drainage guarantying effective discharge of residual condensate. If the manufacturer of the safety valve offers the version with drainage of the expansion chamber of valve body – it should also be considered to use such a valve.
Noise emissions above the limit value (in case of discharge of steams and gasses)	Significant flow rates at medium discharge from the safety valve	In the case of minor exceedances of limit values - consider the possibility of reducing the flow speed through the use of larger safety valve. It should be checked, however, that "oversizing" of the valve did not cause the instability of its work (see "vibrations"). In most cases it is necessary to apply silencer directly behind the valve and screening of the valve (noise barriers). While designing the outlet pipes fitted with silencers, static and dynamic interaction of flow stream flowing through the silencer should be taken into account. Silencer body should not interfere with effective operation of safety valve and additional pressure drops should be taken under consideration while calculating the discharge, and drainage pipes of the valve. In each case it should be considered not to exceed the value of backpressure allowed by the manufacturer of the safety valve.

8. Valve service discontinuity

All obsolete and dismantled valves must not be disposed with household waste. ZETKAMA valves are made of materials which can be re-used and should be delivered to designated recycling centers.

9. Warranty

ZETKAMA grants quality warranty with assurance for proper operation of its products, providing that assembly of them is done according to the user's manual and they are operated according to technical conditions and parameters described in ZETKAMA's catalogue cards. Warranty period is 18 months starting from assembly date, however not longer than 24 months from the sales date.

The guarantee does not cover an assembly of third party spare parts and design changes made by the user, as well as changes in set pressure and natural wear and tear.

The user should inform ZETKAMA about latent defects of the product immediately after they are found.

The complaint must be made in writing.

Other warranty terms are to be agreed between the manufacturer of the valve and the purchaser.



The manufacturer reserves the right to introduce technical changes as the result of improving construction and manufacturing technology.

Failure to comply by the user with the regulations and indications included in this user's manual shall exempt the manufacturer from any liability and warranty.

Address for correspondence:

ZETKAMA Sp. z o.o.
ul. 3 Maja 12
57-410 Ścinawka Średnia

Phone +48 74 86 52 111
Fax +48 74 86 52 101
Website: www.zetkama.com